

Universal Pipe Mount Product Manual

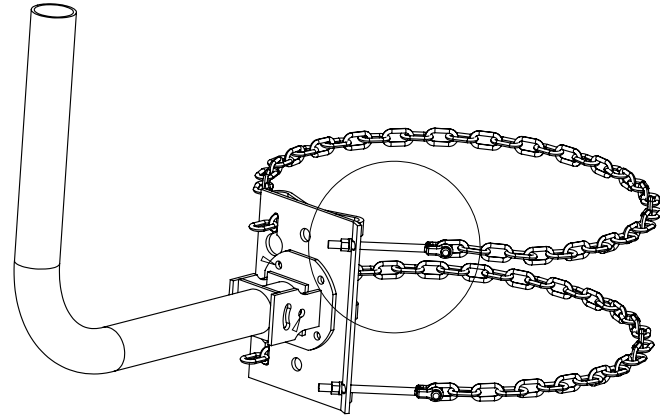

Universal Pipe Mount

ARE Telecom & Broadband

1041 Grand Ave #213

St. Paul, MN 55105

(651) 330-1263

www.aretelecom.com

Proprietary rights are included in the information disclosed herein. This information is submitted in confidence and neither the document nor the information disclosed herein shall be reproduced or transferred to other documents for manufacturing or for any other purpose except as specifically authorized in writing by ARE Telecom & Wind.

REVISIONS			
REV.	DESCRIPTION	DATE	APPROVED
A	initial release	6/25/18	MGC
A-2	Added BOM	7/14/18	MGC

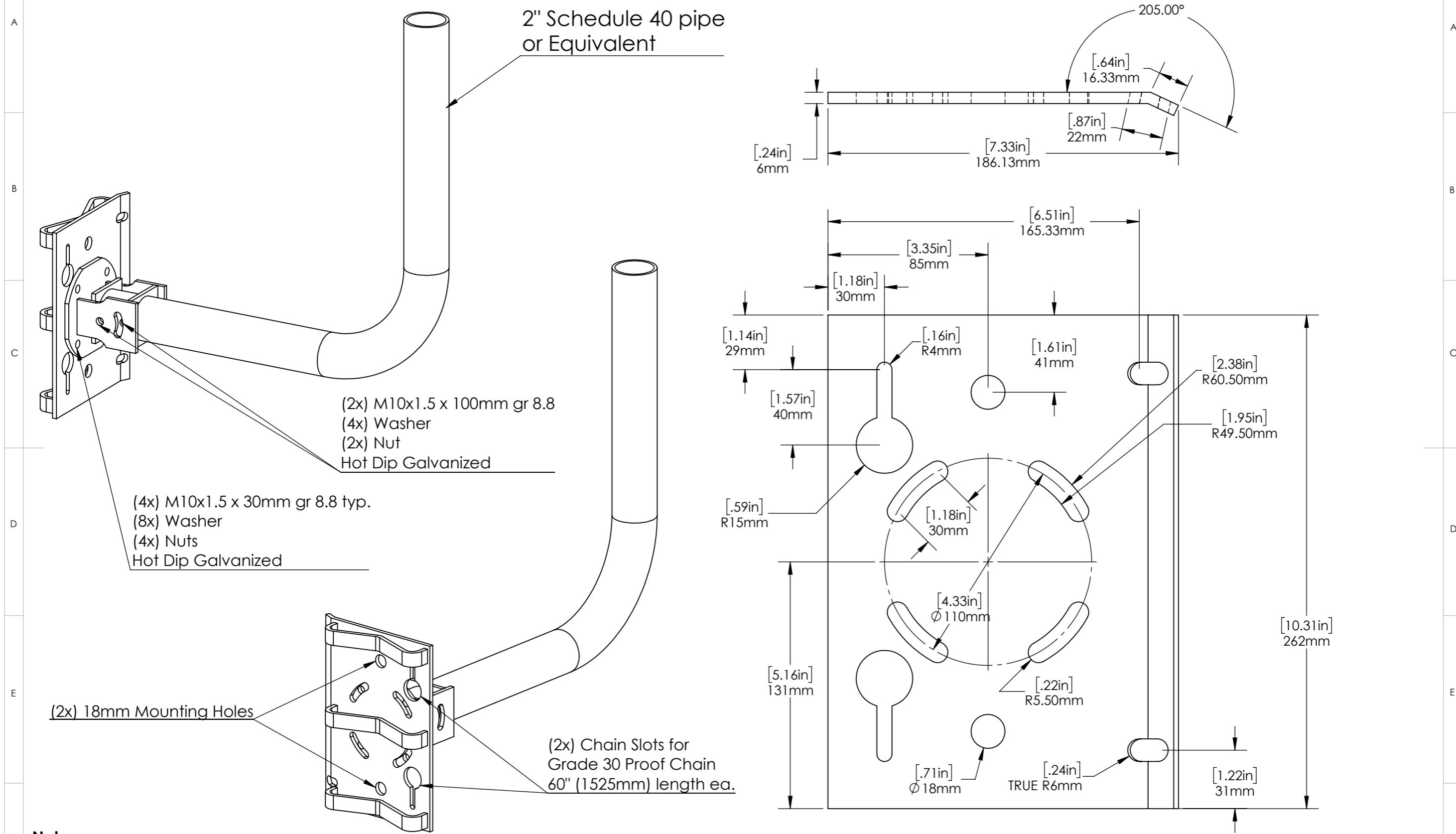

2" Schedule 40 pipe or Equivalent

(2x) M10x1.5 x 100mm gr 8.8
(4x) Washer
(2x) Nut
Hot Dip Galvanized

(4x) M10x1.5 x 30mm gr 8.8 typ.
(8x) Washer
(4x) Nuts
Hot Dip Galvanized

(2x) 18mm Mounting Holes

(2x) Chain Slots for Grade 30 Proof Chain 60" (1525mm) length ea.

Notes:

- All plate material shall have a minimum yield strength of 345 MPa (50 ksi)
- Pipe or Tube shall have a minimum yield strength of 345 MPa (50ksi)
- All welding shall conform to the minimum requirements of AWS D1.1
- All welding shall be done by welders qualified under AWS specifications, using E80XX, low hydrogen electrodes
- Adaptor shall be Hot Dip Galvanized in accordance with ASTM A123
- Debur all sharp edges

CAD-generated drawing do not manually update		ARE Telecom & Wind 1041 Grand Avenue, # 213 St. Paul, MN 55105 (651) 330-1263	
Weight 9.5 kg (21 lbs)		APPROVALS DRAWN MGC CHECKED RESP ENG MFG ENG QUAL ENG	DATE 6/25/18
MATERIAL See Notes FINISH See Notes DO NOT SCALE DRAWING		Antenna Mount CAD file : Details and dimensions not shown on this drawing can be found in CAD file scale NA rev. A-2 size NA 1 of 5	

Proprietary rights are included in the information disclosed herein. This information is submitted in confidence and neither the document nor the information disclosed herein shall be reproduced or transferred to other documents for manufacturing or for any other purpose except as specifically authorized in writing by ARE Telecom & Wind.

A
B
C
D
E
F

A
B
C
D
E
F

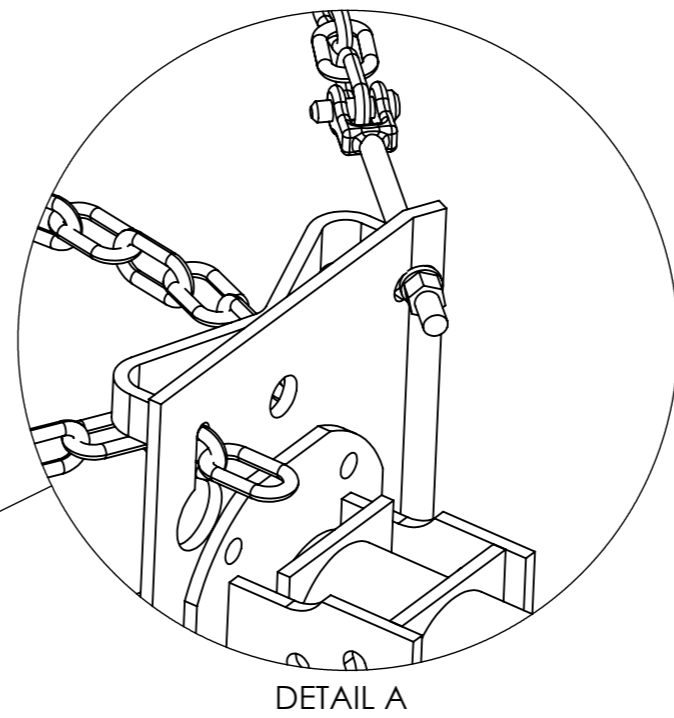
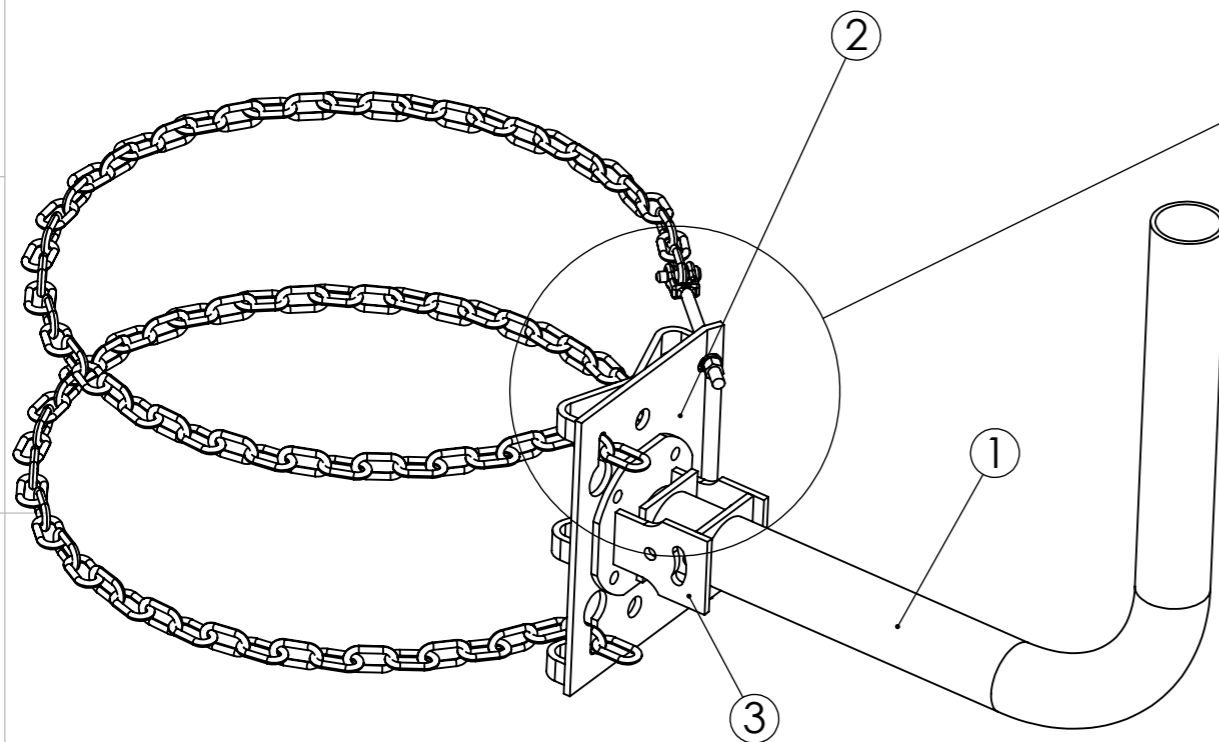

No.	Description	Weight	Qty.
1	2" Sch. 40 Pipe-90deg. Bend (or equivalent)		1
2	Mounting Plate		1
3	Pipe Swivel		1
4	M10x1.5 x 30mm gr 8.8 or equivalent		4
5	M10x1.5 x 100mm gr 8.8 or equivalent		2
4-5	M10 Nut		6
4-5	M10 Washer		12
6	3/8"x6" Jaw End FBolt, Right w/ Nut, Washer - Not Included		
7	1/4" x 5' 30 Proof HDG Chain - Not Included		

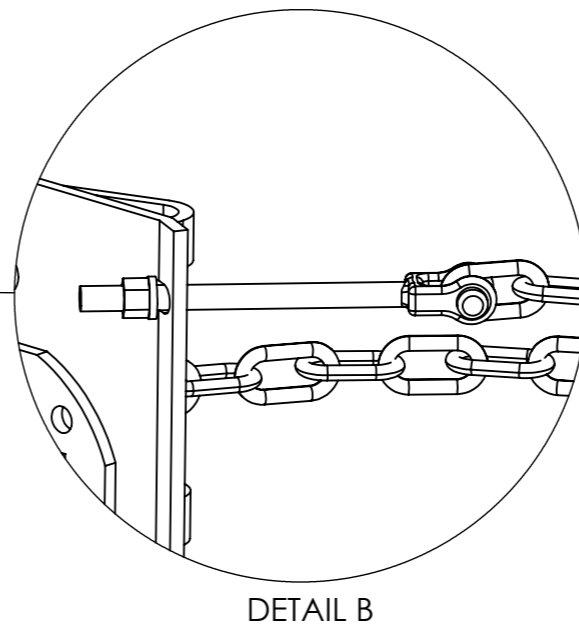
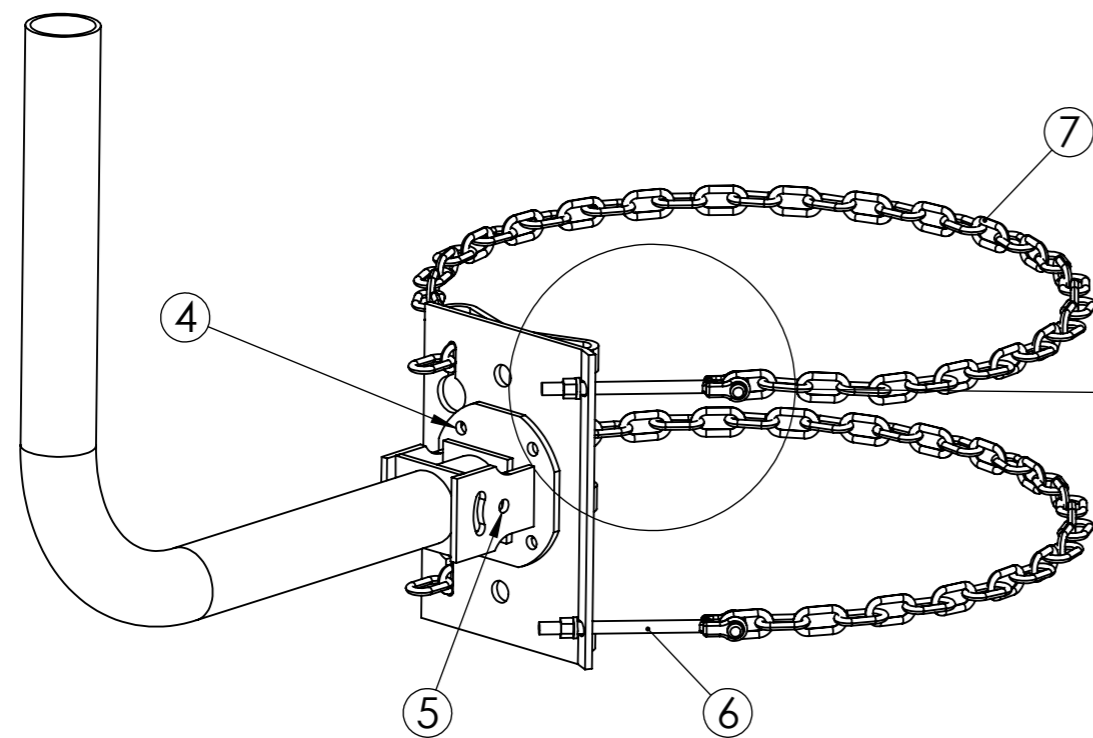

ARE Telecom & Wind
1041 Grand Avenue, # 213
St. Paul, MN 55105
(651) 330-1263

Antenna Chain Mount

Part # AMM-500-CM
scale NA rev. A-2 size NA sheet 5 of 5

1

2

3

4

5

6

7

4) ANALYSIS RESULTS

Table 2 – Mount Classifications - Max Appurtenance Load

Mount Model	Mount Classification	Max Normal Horizontal Load (lbs)	Max Transverse Horizontal Load (lbs)	Max Vertical Load w/ Ice (lbs)
Universal Adjustable Mount	M700R(900)-1[6]	700	700	900

Note: The max normal and transverse loads are representative of an extreme wind condition. The max vertical load with ice is representative of an extreme ice condition. The maximum loads listed are factored loads applied at (1) mast pipe location per sector in accordance with NSTD-445 (TIA/TSB-5053).

Table 3 – Mount Classifications – Max Appurtenance EPA

Mount Model	Max EPA (sqft)				
	180 mph Ult Wind Speed	150 mph Ult Wind Speed	130 mph Ult Wind Speed	110 mph Ult Wind Speed	90 mph Ult Wind Speed
Universal Adjustable Mount	2.6	3.7	5.0	7.0	10.5

Note: The max appurtenance EPA following analysis criteria in Section 2 of this report with varying ultimate wind speeds assuming a Force Coefficient (Ca) of 2.0.

Table 4 – Mount Effective Projected Areas and Weights

Mount Model	Mount EPA _N w/ No Ice (ft ²)	Mount EPA _T w/ No Ice (ft ²)	Mount EPA _N w/ 1/2" Ice (ft ²)	Mount EPA _T w/ 1/2" Ice (ft ²)	Weight (lbs)	Weight w/ 1/2" Ice (lbs)
Universal Adjustable Mount	0.58	0.67	1.16	1.26	11.7	41.5